



Full wall system
HT Safe®: Building Drainage Version 2.0.

Delivery Range 2024

Version 01/2024



Gebr. Ostendorf Kunststoffe GmbH
Rudolf-Diesel-Straße 6-8 · D-49377 Vechta
Tel. +49 (0) 4441 874-10 · Fax +49 (0) 4441 874-15
verkauf@ostendorf-kunststoffe.com
www.ostendorf-kunststoffe.com

WHAT YOU CAN COUNT ON:

Service through and through...

CONTACT PERSONS

Please visit our website: www.ostendorf-kunststoffe.com

QUALITY PRODUCTS MADE IN GERMANY



Factory in Vechta



Factory in Emstek



Factory in Rain am Lech

RELIABLE ORDER PROCESSING



EDI
Reception of orders

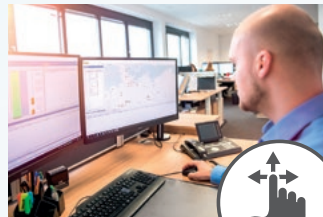

Binding
delivery dates



Order picking



Transport of goods



ALSO OFFERED BY OSTENDORF



Premium quality
for a top price!



Custom solutions
according to client
requirements



DIGITALIZATION

Catalogs on www.oxomi.de 

Technical product data on open datacheck 

VOB conform tendering on www.stlb-bau-online.de 

All tender specifications on AUSSCHREIBEN.DE

BIM-Revit-Data on www.mepcontent.com 

Material properties HT Safe[®]

Sound proof discharge pipes and fittings

Commercial Name

Ostendorf HT Safe[®]

Material

Polypropylene (PP)

- hot water resistant
- permanent low inflammability as per DIN 4102 B1

DIN EN 1451-1

Application

Drainage within the building structure as

- waste water pipe
- rain water pipe
- ventilation pipe

Nominal diameters (DN/OD)

32 / 40 / 50 / 75 / 90 / 110 / 125 / 160

Installation

DIN EN 12056, DIN 1986-100, DIN 4109, VDI 4100

Colour

Traffic grey B RAL 7043

Seal

Patented 3 lip seal, factory inlaid SBR lip seal acc. to DIN 681

Chemical Resistance

Discharge of aggressive media in the range pH1 - pH13
(see also www.ostendorf-kunststoffe.com)

Marking Pipes and Fittings

Permanent marking with manufacturer label, nominal diameter, DIN standard (DIN EN 1451-1), date of manufacture, material, building material class (fire behavior)
(Fittings additionally bear information about the nominal angle.)

Sound Insulation

Measured value 21dB (A)

Sound insulation test according to DIN EN 14366 (Fraunhofer Institute)

Noise emission at 4 litres volume flow according to measurement with Bismat 1000 (P-BA 222/2016).

Central vacuum cleaning system

Test certificate of the State Material Testing Institute Darmstadt

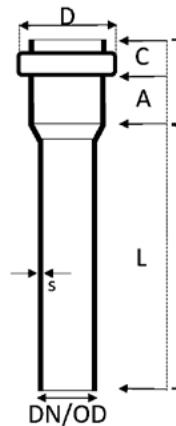

DN/OD	s (mm)	D (mm)	A+C (mm)	L (mm)
32	1,8	44	44	150 – 3000
40	1,8	54	53	150 – 3000
50	1,8	64	52	150 – 3000
75	1,9	89	54	150 – 3000
90	2,2	105	57	150 – 3000
110	2,7	128	61	150 – 3000
125	3,1	144	63	150 – 3000
160	3,9	184	79	150 – 3000

You may find the technical data sheets regarding our products on our website: www.ostendorf-kunststoffe.com



HTsafeEM – Single socket pipe (push-fit)

Part No.	Name	EAN	VPE/Packing	VPE/Pallet
170000	HTsafeEM DN/OD 32 x 150 mm	4052836004284	20	960
170010	HTsafeEM DN/OD 32 x 250 mm	4052836004291	20	800
170020	HTsafeEM DN/OD 32 x 500 mm	4052836004307	20	320
170040	HTsafeEM DN/OD 32 x 1000 mm	4052836004314	10	300
170050	HTsafeEM DN/OD 32 x 1500 mm	4052836004321	10	300
170060	HTsafeEM DN/OD 32 x 2000 mm	4052836004338	10	300
170070	HTsafeEM DN/OD 32 x 3000 mm	4052836004345	10	300
171000	HTsafeEM DN/OD 40 x 150 mm	4052836004475	20	960
171010	HTsafeEM DN/OD 40 x 250 mm	4052836004482	20	960
171020	HTsafeEM DN/OD 40 x 500 mm	4052836004499	20	320
171030	HTsafeEM DN/OD 40 x 750 mm	4052836004505	10	260
171040	HTsafeEM DN/OD 40 x 1000 mm	4052836004512	10	260
171050	HTsafeEM DN/OD 40 x 1500 mm	4052836004529	10	260
171060	HTsafeEM DN/OD 40 x 2000 mm	4052836004536	10	260
171070	HTsafeEM DN/OD 40 x 3000 mm	4052836004543	10	260
172000	HTsafeEM DN/OD 50 x 150 mm	4052836004727	20	720
172010	HTsafeEM DN/OD 50 x 250 mm	4052836004734	20	720
172020	HTsafeEM DN/OD 50 x 500 mm	4052836004741	20	320
172030	HTsafeEM DN/OD 50 x 750 mm	4052836004758	10	200
172040	HTsafeEM DN/OD 50 x 1000 mm	4052836004765	10	200
172050	HTsafeEM DN/OD 50 x 1500 mm	4052836004772	10	200
172060	HTsafeEM DN/OD 50 x 2000 mm	4052836004789	10	200
172070	HTsafeEM DN/OD 50 x 3000 mm	4052836004796	10	200
173000	HTsafeEM DN/OD 75 x 150 mm	4052836005083	20	480
173010	HTsafeEM DN/OD 75 x 250 mm	4052836005090	20	320
173020	HTsafeEM DN/OD 75 x 500 mm	4052836005106	20	160
173030	HTsafeEM DN/OD 75 x 750 mm	4052836005113	6	120
173040	HTsafeEM DN/OD 75 x 1000 mm	4052836005120	6	120
173050	HTsafeEM DN/OD 75 x 1500 mm	4052836005137	6	120
173060	HTsafeEM DN/OD 75 x 2000 mm	4052836005144	6	120
173070	HTsafeEM DN/OD 75 x 3000 mm	4052836005151	6	120

HTsafeEM – Single socket pipe (push-fit)



Part No.	Name	EAN	VPE/Packing	VPE/Pallet
174000	HTsafeEM DN/OD 90 x 150 mm	4052836005380	20	320
174010	HTsafeEM DN/OD 90 x 250 mm	4052836005397	20	240
174020	HTsafeEM DN/OD 90 x 500 mm	4052836005403	10	120
174030	HTsafeEM DN/OD 90 x 750 mm	4052836005410	4	96
174040	HTsafeEM DN/OD 90 x 1000 mm	4052836005427	4	96
174050	HTsafeEM DN/OD 90 x 1500 mm	4052836005434	4	96
174060	HTsafeEM DN/OD 90 x 2000 mm	4052836005441	4	96
174070	HTsafeEM DN/OD 90 x 3000 mm	4052836005458	4	96
175000	HTsafeEM DN/OD 110 x 150 mm	4052836005670	20	160
175010	HTsafeEM DN/OD 110 x 250 mm	4052836005687	20	160
175020	HTsafeEM DN/OD 110 x 500 mm	4052836005694	10	80
175030	HTsafeEM DN/OD 110 x 750 mm	4052836005700	4	60
175040	HTsafeEM DN/OD 110 x 1000 mm	4052836005717	4	60
175050	HTsafeEM DN/OD 110 x 1500 mm	4052836005724	4	60
175060	HTsafeEM DN/OD 110 x 2000 mm	4052836005731	4	60
175070	HTsafeEM DN/OD 110 x 3000 mm	4052836005748	4	60
176000	HTsafeEM DN/OD 125 x 150 mm	4052836006080	10	120
176010	HTsafeEM DN/OD 125 x 250 mm	4052836006097	10	120
176020	HTsafeEM DN/OD 125 x 500 mm	4052836006103	5	60
176030	HTsafeEM DN/OD 125 x 750 mm	4052836006110	1	54
176040	HTsafeEM DN/OD 125 x 1000 mm	4052836006127	1	54
176050	HTsafeEM DN/OD 125 x 1500 mm	4052836006134	1	54
176060	HTsafeEM DN/OD 125 x 2000 mm	4052836006141	1	54
176070	HTsafeEM DN/OD 125 x 3000 mm	4052836006158	1	54
177000	HTsafeEM DN/OD 160 x 150 mm	4052836006301	1	84
177010	HTsafeEM DN/OD 160 x 250 mm	4052836006318	1	56
177020	HTsafeEM DN/OD 160 x 500 mm	4052836006325	1	35
177030	HTsafeEM DN/OD 160 x 750 mm	4052836006332	1	35
177040	HTsafeEM DN/OD 160 x 1000 mm	4052836006349	1	35
177050	HTsafeEM DN/OD 160 x 1500 mm	4052836006356	1	35
177060	HTsafeEM DN/OD 160 x 2000 mm	4052836006363	1	35
177070	HTsafeEM DN/OD 160 x 3000 mm	4052836006370	1	35

HTsafeDM – Double socket pipe



Part No.	Name	EAN	VPE/Packing	VPE/Pallet
178020	HTsafeDM DN/OD 32 x 500 mm	4052836088901	20	320
178040	HTsafeDM DN/OD 32 x 1000 mm	4052836088932	10	300
178050	HTsafeDM DN/OD 32 x 1500 mm	4052836088963	10	300
178060	HTsafeDM DN/OD 32 x 2000 mm	4052836088994	10	300
178070	HTsafeDM DN/OD 32 x 3000 mm	4052836089021	10	300
178120	HTsafeDM DN/OD 40 x 500 mm	4052836089052	20	240
178140	HTsafeDM DN/OD 40 x 1000 mm	4052836089083	10	240
178150	HTsafeDM DN/OD 40 x 1500 mm	4052836089113	10	240
178160	HTsafeDM DN/OD 40 x 2000 mm	4052836089144	10	240
178170	HTsafeDM DN/OD 40 x 3000 mm	4052836089175	10	240
178220	HTsafeDM DN/OD 50 x 500 mm	4052836089205	20	240
178240	HTsafeDM DN/OD 50 x 1000 mm	4052836089236	10	200
178250	HTsafeDM DN/OD 50 x 1500 mm	4052836089267	10	200
178260	HTsafeDM DN/OD 50 x 2000 mm	4052836089298	10	200
178270	HTsafeDM DN/OD 50 x 3000 mm	4052836089328	10	200
178320	HTsafeDM DN/OD 75 x 500 mm	4052836089359	10	120
178340	HTsafeDM DN/OD 75 x 1000 mm	4052836089380	1	104
178350	HTsafeDM DN/OD 75 x 1500 mm	4052836089403	1	104
178360	HTsafeDM DN/OD 75 x 2000 mm	4052836089427	1	104
178370	HTsafeDM DN/OD 75 x 3000 mm	4052836089441	1	104
178420	HTsafeDM DN/OD 90 x 500 mm	4052836089465	10	90
178440	HTsafeDM DN/OD 90 x 1000 mm	4052836089496	4	96
178450	HTsafeDM DN/OD 90 x 1500 mm	4052836089526	4	96
178460	HTsafeDM DN/OD 90 x 2000 mm	4052836089557	4	96
178470	HTsafeDM DN/OD 90 x 3000 mm	4052836089588	4	96
178520	HTsafeDM DN/OD 110 x 500 mm	4052836089618	6	54
178540	HTsafeDM DN/OD 110 x 1000 mm	4052836089649	1	54
178550	HTsafeDM DN/OD 110 x 1500 mm	4052836089663	1	54
178560	HTsafeDM DN/OD 110 x 2000 mm	4052836089687	1	54
178570	HTsafeDM DN/OD 110 x 3000 mm	4052836089700	1	54
178620	HTsafeDM DN/OD 125 x 500 mm	4052836089724	1	48
178640	HTsafeDM DN/OD 125 x 1000 mm	4052836089748	4	48
178650	HTsafeDM DN/OD 125 x 1500 mm	4052836089779	4	48
178660	HTsafeDM DN/OD 125 x 2000 mm	4052836089809	4	48
178670	HTsafeDM DN/OD 125 x 3000 mm	4052836089830	1	48

HTsafeGL – Plain ended pipe without sleeve



Part No.	Name	EAN	VPE/Packing	VPE/Pallet
170080	HTsafeGL DN/OD 32 x 5000 mm	4052836004352	1	300
171080	HTsafeGL DN/OD 40 x 5000 mm	4052836004550	1	260
172080	HTsafeGL DN/OD 50 x 5000 mm	4052836004802	1	200
173080	HTsafeGL DN/OD 75 x 5000 mm	4052836005168	1	120
174080	HTsafeGL DN/OD 90 x 5000 mm	4052836005465	1	96
175080	HTsafeGL DN/OD 110 x 5000 mm	4052836005755	1	60
176080	HTsafeGL DN/OD 125 x 5000 mm	4052836006165	1	54
177080	HTsafeGL DN/OD 160 x 5000 mm	4052836006387	1	35

HTsafeB – Bend



15 Degrees



30 Degrees

Part No.	Name	EAN	VPE/ Cardboard Box	VPE/Pallet
170100	HTsafeB Bend DN/OD 32 15 Degrees	4052836004369	20	1400
170110	HTsafeB Bend DN/OD 32 30 Degrees	4052836004376	20	1400
170120	HTsafeB Bend DN/OD 32 45 Degrees	4052836004383	20	1400
170130	HTsafeB Bend DN/OD 32 67,5 Degrees	4052836004390	20	1400
170140	HTsafeB Bend DN/OD 32 87,5 Degrees	4052836004406	20	1400
171100	HTsafeB Bend DN/OD 40 15 Degrees	4052836004567	20	960
171110	HTsafeB Bend DN/OD 40 30 Degrees	4052836004574	20	960
171120	HTsafeB Bend DN/OD 40 45 Degrees	4052836004581	20	960
171130	HTsafeB Bend DN/OD 40 67,5 Degrees	4052836004598	20	960
171140	HTsafeB Bend DN/OD 40 87,5 Degrees	4052836004604	20	960
172100	HTsafeB Bend DN/OD 50 15 Degrees	4052836004819	20	960
172110	HTsafeB Bend DN/OD 50 30 Degrees	4052836004826	20	960
172120	HTsafeB Bend DN/OD 50 45 Degrees	4052836004833	20	960
172130	HTsafeB Bend DN/OD 50 67,5 Degrees	4052836004840	20	960
172140	HTsafeB Bend DN/OD 50 87,5 Degrees	4052836004857	20	960



45 Degrees



67,5 Degrees



87,5 Degrees

HTsafeB – Bend

Part No.	Name	EAN	VPE/ Cardboard Box	VPE/Pallet
173100	HTsafeB Bend DN/OD 75 15 Degrees	4052836005175	20	480
173110	HTsafeB Bend DN/OD 75 30 Degrees	4052836005182	20	480
173120	HTsafeB Bend DN/OD 75 45 Degrees	4052836005199	20	480
173130	HTsafeB Bend DN/OD 75 67,5 Degrees	4052836005205	20	480
173140	HTsafeB Bend DN/OD 75 87,5 Degrees	4052836005212	20	480
174100	HTsafeB Bend DN/OD 90 15 Degrees	4052836005472	20	400
174110	HTsafeB Bend DN/OD 90 30 Degrees	4052836005489	20	400
174120	HTsafeB Bend DN/OD 90 45 Degrees	4052836005496	20	400
174130	HTsafeB Bend DN/OD 90 67,5 Degrees	4052836005502	20	240
174140	HTsafeB Bend DN/OD 90 87,5 Degrees	4052836005519	20	240
175100	HTsafeB Bend DN/OD 110 15 Degrees	4052836005762	20	240
175110	HTsafeB Bend DN/OD 110 30 Degrees	4052836005779	20	240
175120	HTsafeB Bend DN/OD 110 45 Degrees	4052836005786	20	240
175130	HTsafeB Bend DN/OD 110 67,5 Degrees	4052836005793	20	160
175140	HTsafeB Bend DN/OD 110 87,5 Degrees	4052836005809	20	160
176100	HTsafeB Bend DN/OD 125 15 Degrees	4052836006172	20	160
176110	HTsafeB Bend DN/OD 125 30 Degrees	4052836006189	20	160
176120	HTsafeB Bend DN/OD 125 45 Degrees	4052836006196	20	160
176140	HTsafeB Bend DN/OD 125 87,5 Degrees	4052836006202	10	120
177100	HTsafeB Bend DN/OD 160 15 Degrees	4052836006394	10	80
177110	HTsafeB Bend DN/OD 160 30 Degrees	4052836006400	10	80
177120	HTsafeB Bend DN/OD 160 45 Degrees	4052836006417	5	60
177140	HTsafeB Bend DN/OD 160 87,5 Degrees	4052836006424	5	60

HTsafeEA – Branch



45 Degrees

Part No.	Name	EAN	VPE/ Cardboard Box	VPE/Pallet
170200	HTsafeEA Branch DN/OD 32/32 45 Degrees	4052836004413	20	960
170300	HTsafeEA Branch DN/OD 32/32 67,5 Degrees	4052836004420	20	960
170400	HTsafeEA Branch DN/OD 32/32 87,5 Degrees	4052836004437	20	960

171200	HTsafeEA Branch DN/OD 40/40 45 Degrees	4052836004611	20	960
171300	HTsafeEA Branch DN/OD 40/40 67,5 Degrees	4052836004628	20	960
171400	HTsafeEA Branch DN/OD 40/40 87,5 Degrees	4052836004635	20	960

172210	HTsafeEA Branch DN/OD 50/40 45 Degrees	4052836004871	20	480
172200	HTsafeEA Branch DN/OD 50/50 45 Degrees	4052836004864	20	480
172310	HTsafeEA Branch DN/OD 50/40 67,5 Degrees	4052836004895	20	480
172300	HTsafeEA Branch DN/OD 50/50 67,5 Degrees	4052836004888	20	480
172410	HTsafeEA Branch DN/OD 50/40 87,5 Degrees	4052836004918	20	480
172400	HTsafeEA Branch DN/OD 50/50 87,5 Degrees	4052836004901	20	480

173210	HTsafeEA Branch DN/OD 75/50 45 Degrees	4052836005236	20	400
173200	HTsafeEA Branch DN/OD 75/75 45 Degrees	4052836005229	20	240
173310	HTsafeEA Branch DN/OD 75/50 67,5 Degrees	4052836005250	20	480
173300	HTsafeEA Branch DN/OD 75/75 67,5 Degrees	4052836005243	20	240
173410	HTsafeEA Branch DN/OD 75/50 87,5 Degrees	4052836005274	20	400
173400	HTsafeEA Branch DN/OD 75/75 87,5 Degrees	4052836005267	20	240

174220	HTsafeEA Branch DN/OD 90/50 45 Degrees	4052836005540	20	240
174210	HTsafeEA Branch DN/OD 90/75 45 Degrees	4052836005533	20	240
174200	HTsafeEA Branch DN/OD 90/90 45 Degrees	4052836005526	20	160
174420	HTsafeEA Branch DN/OD 90/50 87,5 Degrees	4052836005571	20	240
174410	HTsafeEA Branch DN/OD 90/75 87,5 Degrees	4052836005564	20	240
174400	HTsafeEA Branch DN/OD 90/90 87,5 Degrees	4052836005557	20	160



67,5 Degrees



87,5 Degrees

HTsafeEA – Branch

Part No.	Name	EAN	VPE/ Cardboard Box	VPE/Pallet
175220	HTsafeEA Branch DN/OD 110/50 45 Degrees	4052836005830	20	240
175210	HTsafeEA Branch DN/OD 110/75 45 Degrees	4052836005823	20	160
175230	HTsafeEA Branch DN/OD 110/90 45 Degrees	4052836143518	10	120
175200	HTsafeEA Branch DN/OD 110/110 45 Degrees	4052836005816	8	96
175320	HTsafeEA Branch DN/OD 110/50 67,5 Degrees	4052836005861	20	240
175310	HTsafeEA Branch DN/OD 110/75 67,5 Degrees	4052836005854	20	160
175300	HTsafeEA Branch DN/OD 110/110 67,5 Degrees	4052836005847	10	120
175420	HTsafeEA Branch DN/OD 110/50 87,5 Degrees	4052836005885	20	240
175410	HTsafeEA Branch DN/OD 110/75 87,5 Degrees	4052836005878	20	160
175430	HTsafeEA Branch DN/OD 110/90 87,5 Degrees	4052836143549	10	120
175400	HTsafeEA Branch DN/OD 110/110 87,5 Degrees	4052836008787	8	96
176210	HTsafeEA Branch DN/OD 125/110 45 Degrees	4052836006226	5	60
176200	HTsafeEA Branch DN/OD 125/125 45 Degrees	4052836006219	5	60
176410	HTsafeEA Branch DN/OD 125/110 87,5 Degrees	4052836006240	5	60
176400	HTsafeEA Branch DN/OD 125/125 87,5 Degrees	4052836006233	5	60
177210	HTsafeEA Branch DN/OD 160/110 45 Degrees	4052836006448	5	40
177200	HTsafeEA Branch DN/OD 160/160 45 Degrees	4052836006431	4	32
177410	HTsafeEA Branch DN/OD 160/110 87,5 Degrees	4052836006462	5	60
177400	HTsafeEA Branch DN/OD 160/160 87,5 Degrees	4052836006455	4	48

HTsafeDA – Double Branch

Part No.	Name	EAN	VPE Cardboard Box	VPE/Pallet
172900	HTsafeDA Double Branch DN/OD 50/50/50 67,5 Degrees	4052836005021	20	480
173900	HTsafeDA Double Branch DN/OD 75/75/75 67,5 Degrees	4052836005373	20	240
174900	HTsafeDA Double Branch DN/OD 90/90/90 87,5 Degrees (swept)*	4052836005663	8	96
175910	HTsafeDA Double Branch DN/OD 110/50/50 67,5 Degrees	4052836006066	10	120
175900	HTsafeDA Double Branch DN/OD 110/110/110 67,5 Degrees	4052836006059	5	60
175930	HTsafeDA Double Branch DN/OD 110/110/110 87,5 Degrees (swept)*	4052836136022	5	60

*with improved branch design for a better flow

HTsafeSA – Plug-in branch

Part No.	Name	EAN	VPE Cardboard Box	VPE/Pallet
175740	HTsafeSA Plug-in branch DN/OD 110/110 87,5 Degrees	4052836135711	8	96





HTsafeDSW – Double Connection Bend

Part No.	Name	EAN	VPE/ Cardboard Box	VPE/Pallet
172970	HTsafeDSW Double Connection Bend DN/OD 40/50/40	4052836005076	20	480



HTsafeED – Corner Double Branch

Part No.	Name	EAN	VPE/ Cardboard Box	VPE/Pallet
175920	HTsafeED Corner Double Branch DN/OD 110/110/110 67,5 Degrees	4052836006073	10	80



HTsafeU – Coupler

Part No.	Name	EAN	VPE/ Cardboard Box	VPE/Pallet
170500	HTsafeU Coupler DN/OD 32	4052836004444	20	1400
171500	HTsafeU Coupler DN/OD 40	4052836004642	20	960
172500	HTsafeU Coupler DN/OD 50	4052836004925	20	960
173500	HTsafeU Coupler DN/OD 75	4052836005281	20	480
174500	HTsafeU Coupler DN/OD 90	4052836005588	20	480
175500	HTsafeU Coupler DN/OD 110	4052836005892	20	240
176500	HTsafeU Coupler DN/OD 125	4052836006257	20	160
177500	HTsafeU Coupler DN/OD 160	4052836006479	15	120



Skolan Safe – Connection to HT Safe

Part No.	Name	EAN	VPE/ Cardboard Box	VPE/Pallet
333830	SKOLANsafe Connection to HT Safe DN/OD 75	4052836338303	20	480
336820	SKOLANsafe Connection to HT Safe/KG DN/OD 125	4052836368201	4	160

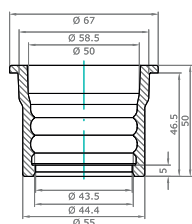

Skolan Safe – Transition sleeve

Part No.	Name	EAN	VPE/ Cardboard Box	VPE/Pallet
910833	SKOLANsafe Transition sleeve Skolan Safe 58 / HT Safe 50 mm	4052836086754	20	2560



HTsafeUG – Connection piece to cast-iron pipe

Part No.	Name	EAN	VPE/ Cardboard Box	VPE/Pallet
172820	HTsafeUG Connection piece to cast-iron pipe DN/OD 50	4052836005014	20	960
173820	HTsafeUG Connection piece to cast-iron pipe DN/OD 75	4052836005366	20	480
175820	HTsafeUG Connection piece to cast-iron pipe DN/OD 110	4052836006042	20	480



HTsafeM – Plug

Part No.	Name	EAN	VPE/ Cardboard Box	VPE/Pallet
170620	HTsafeM Plug DN/OD 32	4052836004468	100	7000
171620	HTsafeM Plug DN/OD 40	4052836004666	20	2880
172620	HTsafeM Plug DN/OD 50	4052836004956	20	2880
173620	HTsafeM Plug DN/OD 75	4052836005311	20	2560
174620	HTsafeM Plug DN/OD 90	4052836005618	20	960
175620	HTsafeM Plug DN/OD 110	4052836005922	20	960
176620	HTsafeM Plug DN/OD 125	4052836006288	20	480
177620	HTsafeM Plug DN/OD 160	4052836006509	20	480



HTsafeMM – Double socket

Part No.	Name	EAN	VPE/ Cardboard Box	VPE/Pallet
170510	HTsafeMM Double socket DN/OD 32	4052836004451	20	1400
171510	HTsafeMM Double socket DN/OD 40	4052836004659	20	960
172510	HTsafeMM Double socket DN/OD 50	4052836004932	20	960
173510	HTsafeMM Double socket DN/OD 75	4052836005298	20	480
174510	HTsafeMM Double socket DN/OD 90	4052836005595	20	480
175510	HTsafeMM Double socket DN/OD 110	4052836005908	20	240
176510	HTsafeMM Double socket DN/OD 125	4052836006264	20	160
177510	HTsafeMM Double socket DN/OD 160	4052836006486	15	120

HTsafeR – Reducer, eccentric



Part No.	Name	EAN	VPE/ Cardboard Box	VPE/Pallet
171710	HTsafeR Reducer DN/OD 40/32	4052836004673	20	1400
172720	HTsafeR Reducer DN/OD 50/32	4052836004987	20	960
172710	HTsafeR Reducer DN/OD 50/40	4052836004963	20	960
173710	HTsafeR Reducer DN/OD 75/50	4052836005328	12	576
174720	HTsafeR Reducer DN/OD 90/50	4052836005632	20	480
174710	HTsafeR Reducer DN/OD 90/75	4052836005625	20	480
175720	HTsafeR Reducer DN/OD 110/50	4052836005977	20	400
175710	HTsafeR Reducer DN/OD 110/75	4052836005953	20	480
175700	HTsafeR Reducer DN/OD 110/90	4052836005939	20	240
176710	HTsafeR Reducer DN/OD 125/110	4052836006295	20	240
177710	HTsafeR Reducer DN/OD 160/110	4052836006523	20	160
177700	HTsafeR Reducer DN/OD 160/125	4052836006516	20	160

HTsafeR – Reducer, short



Part No.	Name	EAN	VPE/ Cardboard Box	VPE/Pallet
172715	HTsafeR Reducer DN/OD 50/40 Short Version	4052836004970	20	1400
173715	HTsafeR Reducer DN/OD 75/50 Short Version	4052836005335	20	960
174730	HTsafeR Reducer DN/OD 90/50 Short Version	4052836005649	20	480
175725	HTsafeR Reducer DN/OD 110/50 Short Version	4052836005984	20	480
175715	HTsafeR Reducer DN/OD 110/75 Short Version	4052836005960	20	480
175705	HTsafeR Reducer DN/OD 110/90 Short Version	4052836005946	20	480

HTsafeRE – Cleaning Pipe



Part No.	Name	EAN	VPE/ Cardboard Box	VPE/Pallet
172600	HTsafeRE Cleaning Pipe DN/OD 50	4052836004949	20	480
173600	HTsafeRE Cleaning Pipe DN/OD 75	4052836005304	20	480
174600	HTsafeRE Cleaning Pipe DN/OD 90	4052836005601	20	240
175600	HTsafeRE Cleaning Pipe DN/OD 110	4052836005915	20	160
176600	HTsafeRE Cleaning Pipe DN/OD 125	4052836006271	5	60
177600	HTsafeRE Cleaning Pipe DN/OD 160	4052836006493	5	60



HTsafeRI – Inner reducer

Part No.	Name	EAN	VPE/ Cardboard Box	VPE/Pallet
175770	HTsafeRI Inner reducer DN/OD 110/50	4052836006011	20	960
175760	HTsafeRI Inner reducer DN/OD 110/75	4052836006004	20	480



HTsafeL – Long socket

Part No.	Name	EAN	VPE/ Cardboard Box	VPE/Pallet
171800	HTsafeL Long socket DN/OD 40	4052836004680	20	960
172800	HTsafeL Long socket DN/OD 50	4052836004994	20	480
173800	HTsafeL Long socket DN/OD 75	4052836005342	20	480
174800	HTsafeL Long socket DN/OD 90	4052836005656	20	240
175800	HTsafeL Long socket DN/OD 110	4052836006028	20	160



HTsafeS – Siphon connection piece to metal and plastic

Part No.	Name	EAN	VPE/ Cardboard Box	VPE/Pallet
171900	HTsafeS Siphon connection piece to metal and plastic DN/OD 40/40	4052836004697	20	2880
172910	HTsafeS Siphon connection piece to metal and plastic DN/OD 50/40	4052836005038	20	2880
172920	HTsafeS Siphon connection piece to metal and plastic DN/OD 50/50	4052836005045	20	960



HTsafeSW – Angled siphon connection piece to metal and plastic

Part No.	Name	EAN	VPE/ Cardboard Box	VPE/Pallet
171910	HTsafeSW Angled siphon connection piece to metal and plastic DN/OD 40/30	4052836004703	20	960
171920	HTsafeSW Angled siphon connection piece to metal and plastic DN/OD 40/40	4052836004710	20	960
172940	HTsafeSW Angled siphon connection piece to metal and plastic DN/OD 50/40	4052836005052	20	960
172950	HTsafeSW Angled siphon connection piece to metal and plastic DN/OD 50/50	4052836005069	20	960



HTsafeSM – Plug-in socket

Part No.	Name	EAN	VPE/ Cardboard Box	VPE/Pallet
175750	HTsafeSM Plug-in socket DN/OD 110/110	4052836005991	36	288



HTsafeAM – Single socket

Part No.	Name	EAN	VPE/ Cardboard Box	VPE/Pallet
172810	HTsafeAM Single socket DN/OD 50	4052836005007	20	480
173810	HTsafeAM Single socket DN/OD 75	4052836005359	20	480
175810	HTsafeAM Single socket DN/OD 110	4052836006035	20	240



HT Safe® – Replacement Lip seal SBR

Part No.	Name	EAN	VPE/ Cardboard Box	VPE/Pallet
880007	Replacement Lip seal SBR DN/OD 32 (HT Safe)	4052836003928	-	-
880017	Replacement Lip seal SBR DN/OD 40 (HT Safe)	4052836003942	-	-
880027	Replacement Lip seal SBR DN/OD 50 (HT Safe)	4052836003966	-	-
880037	Replacement Lip seal SBR DN/OD 75 (HT Safe)	4052836003980	-	-
880047	Replacement Lip seal SBR DN/OD 90 (HT Safe/Skolan Safe)	4052836003768	-	-
880057	Replacement Lip seal SBR DN/OD 110 (HT Safe)	4052836800558	-	-
880077	Replacement Lip seal SBR DN/OD 125 (HT Safe)	4052836004000	-	-
880087	Replacement Lip seal SBR DN/OD 160 (HT Safe)	4052836004024	-	-



HT Safe® – Replacement Lip seal NBR (resistant against oils)

Part No.	Name	EAN	VPE/ Cardboard Box	VPE/Pallet
880217	Replacement Lip seal NBR DN/OD 40 (HT Safe)	4052836004048	-	-
880227	Replacement Lip seal NBR DN/OD 50 (HT Safe)	4052836004062	-	-
880237	Replacement Lip seal NBR DN/OD 75 (HT Safe)	4052836004086	-	-
880247	Replacement Lip seal NBR DN/OD 90 (HT Safe, Skolan Safe)	4052836004109	-	-
880260	Replacement Lip seal NBR DN/OD 110 (KG PVC SN 4, HT Safe)	4052836802606	-	-
880275	Replacement Lip seal NBR DN/OD 125 (KG PVC SN 4, HT Safe)	4052836802750	-	-
880290	Replacement Lip seal NBR DN/OD 160 (KG PVC SN 4, HT Safe)	4052836802903	-	-



HTsafeGA – Gasket

Part No.	Name	EAN	VPE/ Cardboard Box	VPE/Pallet
881005	GA Gasket DN/OD 50	4052836810052	36	-
881015	GA Gasket DN/OD 75	4052836810151	30	-
881025	GA Gasket DN/OD 110	4052836810250	16	-



HTsafeGM – Gasket for siphon bend

Part No.	Name	EAN	VPE/ Cardboard Box	VPE/Pallet
881200	HTGM Gasket for siphon bend DN/OD 40/30 A	4052836812001	20	-
881210	HTGM Gasket for siphon bend DN/OD 40/30 B	4052836812100	20	-
881220	HTGM Gasket for siphon bend DN/OD 40/40 C	4052836812209	20	-
881230	HTGM Gasket for siphon bend DN/OD 40/50/1 1/4	4052836812308	20	-
881240	HTGM Gasket for siphon bend DN/OD 50/30 D	4052836812407	20	-
881250	HTGM Gasket for siphon bend DN/OD 50/40 E	4052836812506	20	-
881260	HTGM Gasket for siphon bend DN/OD 50/50 F	4052836812605	20	-

Part No.	Name	Suitable for	Metal pipe Ø
881200	HTsafeGM Gasket for siphon bend DN/OD 40/30 A	HTsafeSW 40/30 (Part No. 171910)	28 – 34 mm
881210	HTsafeGM Gasket for siphon bend DN/OD 40/30 B	HTsafeS 40/40 (Part No. 171900) HTsafeS 50/40 (Part No. 172910) HTsafeSW 40/40 (Part No. 171920) HTsafeSW 50/40 (Part No. 172940) HTsafeDSW 40/50/40 (Part No. 172970)	28 – 34 mm
881220	HTsafeGM Gasket for siphon bend DN/OD 40/40 C	HTsafeS 40/40 (Part No. 171900) HTsafeS 50/40 (Part No. 172910) HTsafeSW 40/40 (Part No. 171920) HTsafeSW 50/40 (Part No. 172940) HTsafeDSW 40/50/40 (Part No. 172970)	38 – 44 mm
881230	HTsafeGM Gasket for siphon bend DN/OD 40/50/1 1/4	For all pipes and fittings with spigot end DN/OD 50	28 – 30 mm
881240	HTsafeGM Gasket for siphon bend DN/OD 50/30 D	HTsafeS 50/50 (Part No. 172920) HTsafeSW 50/50 (Part No. 172950)	28 – 34 mm
881250	HTsafeGM Gasket for siphon bend DN/OD 50/40 E	HTsafeS 50/50 (Part No. 172920) HTsafeSW 50/50 (Part No. 172950)	38 – 44 mm
881260	HTsafeGM Gasket for siphon bend DN/OD 50/50 F	HTsafeS 50/50 (Part No. 172920) HTsafeSW 50/50 (Part No. 172950)	48 – 54 mm

HT Safe® – Pull-out Protection



Part No.	Name	EAN	VPE/ Cardboard Box	VPE/Pallet
881590	Pull-out Protection DN/OD 32	4052836098474	18	-
881595	Pull-out Protection DN/OD 40	4052836098504	14	-
881500	Pull-out Protection DN/OD 50	4052836815002	50	-
881510	Pull-out Protection DN/OD 75	4052836815101	30	-
881520	Pull-out Protection DN/OD 90	4052836815200	20	-
881535	Pull-out Protection DN/OD 110	4052836086808	26	-
881540	Pull-out Protection DN/OD 125	4052836815408	15	-
881555	Pull-out Protection DN/OD 160	4052836152459	10	-

HT Safe® – Lubricant



Part No.	Name	EAN	VPE/ Cardboard Box	VPE/Pallet
881800	Lubricant 150 ml	4052836818003	50	-
881810	Lubricant 250 ml	4052836818102	50	-
881820	Lubricant 500 ml	4052836818201	24	-
881830	Lubricant 1.000 ml	4052836818300	12	-
881840	Lubricant 3.000 ml bucket	4052836123749	1	-

HT Safe® – Rubber nipple for metal pipes



Part No.	Name	EAN	VPE/ Cardboard Box	VPE/Pallet
881309-07	Rubber nipple for metal pipes DN/OD 40 1 1/4"	4025075007415	30	-
881319-07	Rubber nipple for metal pipes DN/OD 50 1 1/2"	4050463100737	30	-
881329-07	Rubber nipple for metal pipes DN/OD 50 1 1/4"	4050463100720	30	-

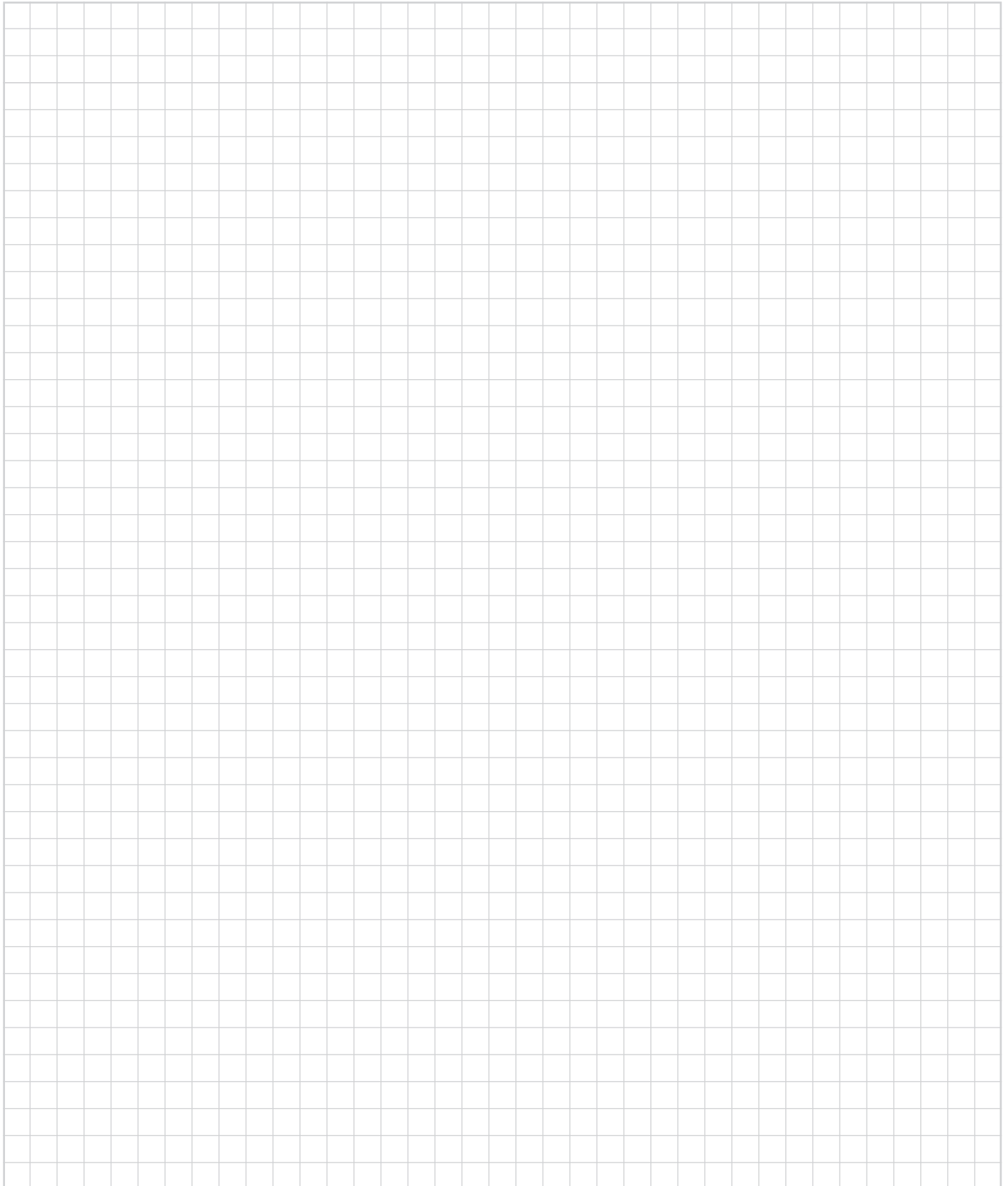

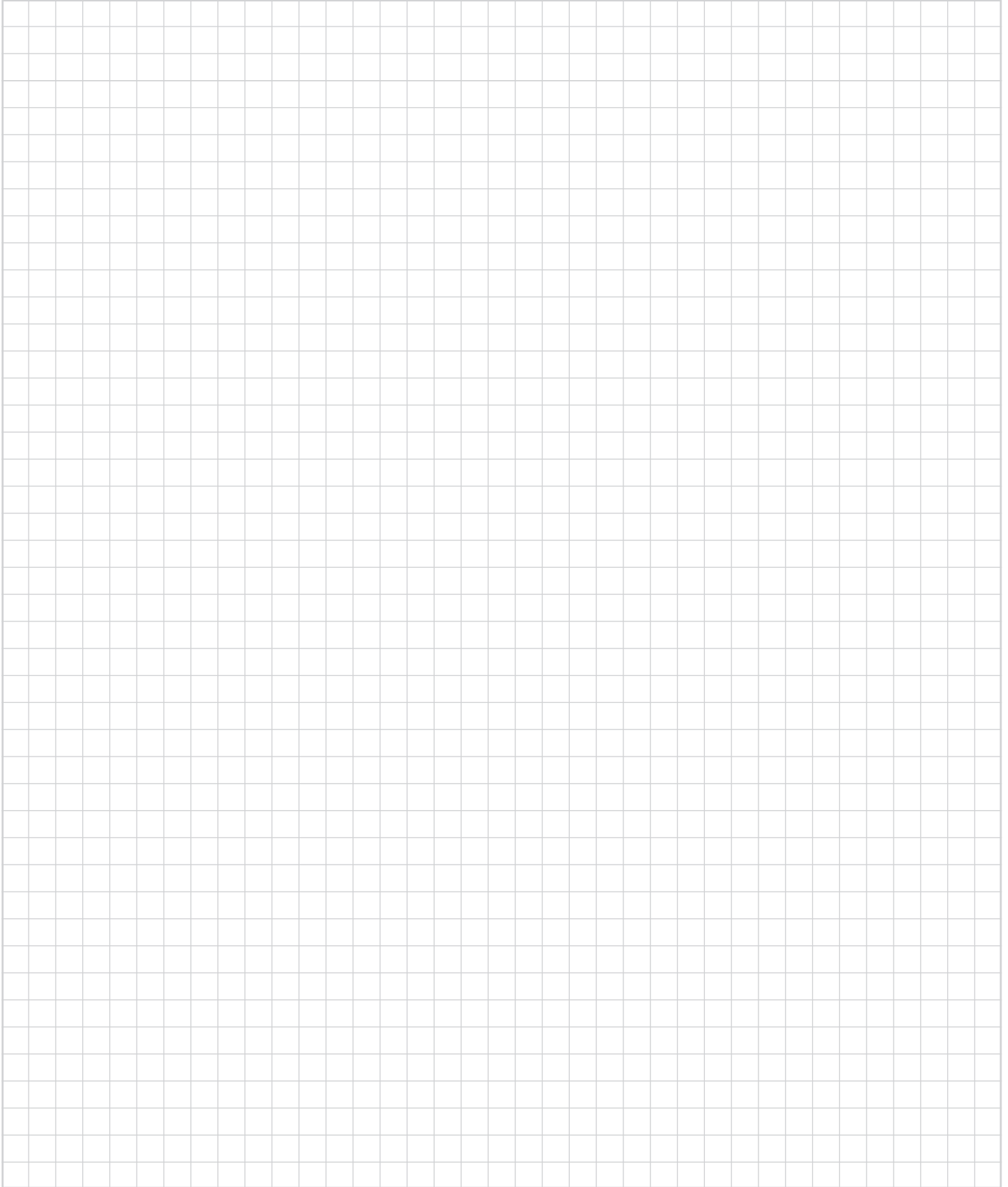

One thing is sure.



Gebr. Ostendorf Kunststoffe

